

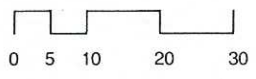







SITE PLAN
DIMENSIONS IN METRES



LEGEND

-  EXTERNAL WALLS
-  BUILDINGS
-  INSTU CONCRETE
-  CONCRETE PAVER
-  BITUMEN
-  BRICK PAVING

SITE PLAN, MAJOR DIMENSIONS & AREAS				
 Maitland Consulting Structural Engineering 5/ 531 Hay St. Subiaco W.A. 6008 Telephone : (08) 9489 4800 Facsimile : (08) 9489 4801 Email : ianmcse@inet.net.au	CLIENT	TOWN OF COTTESLOE	DATE	MARCH 2003
	PROJECT	COTTESLOE CIVIC CENTRE EXTERNAL WALLS AND PAVING	JOB NO.	0075
	TITLE	STRUCTURAL CONSERVATION WORKS	DWG No.	SC-1

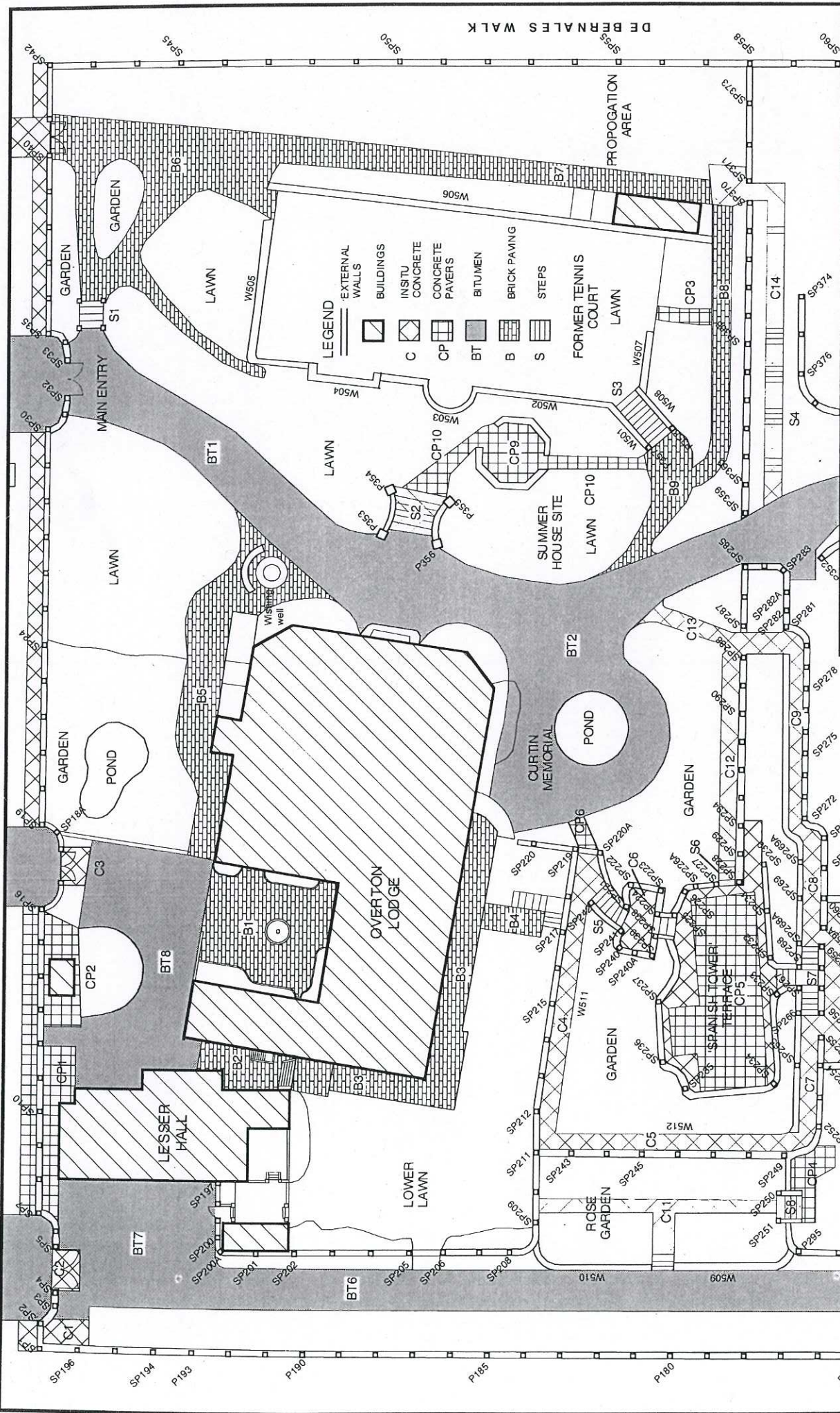

LEGEND

[Hatched pattern]	EXTERNAL WALLS
[Hatched pattern]	BUILDINGS
[Diagonal lines /]	INSITU CONCRETE
[Diagonal lines \]	CONCRETE PAVERS
[Stippled pattern]	BITUMEN
[Cross-hatched pattern]	BRICK PAVING
[Horizontal lines]	STEPS
[Vertical lines]	FORMER TENNIS COURT
[Blank]	LAWN

DATE	MARCH 03
JOB NO.	0075
CLIENT	TOWN OF COTTLESLOE
PROJECT	COTTLESLOE CIVIC CENTRE EXTERNAL WALLS AND PAVING
TITLE	STRUCTURAL CONSERVATION WORKS
DWG No.	SC 4

Maitland
 Consulting Structural Engineering
 Telephone : (08) 9489 4800
 Facsimile : (08) 9489 4801
 E-mail : ianmce@inet.net.au

MC SIE
 5/ 531 Hay St.
 Subiaco
 W.A. 6008

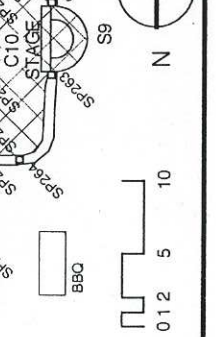

AREA A

SP - BALUSTRADES/PIER OVER
 P - BALUSTRADES/PIER UNDER
 W - WALLS WITHOUT PIERS

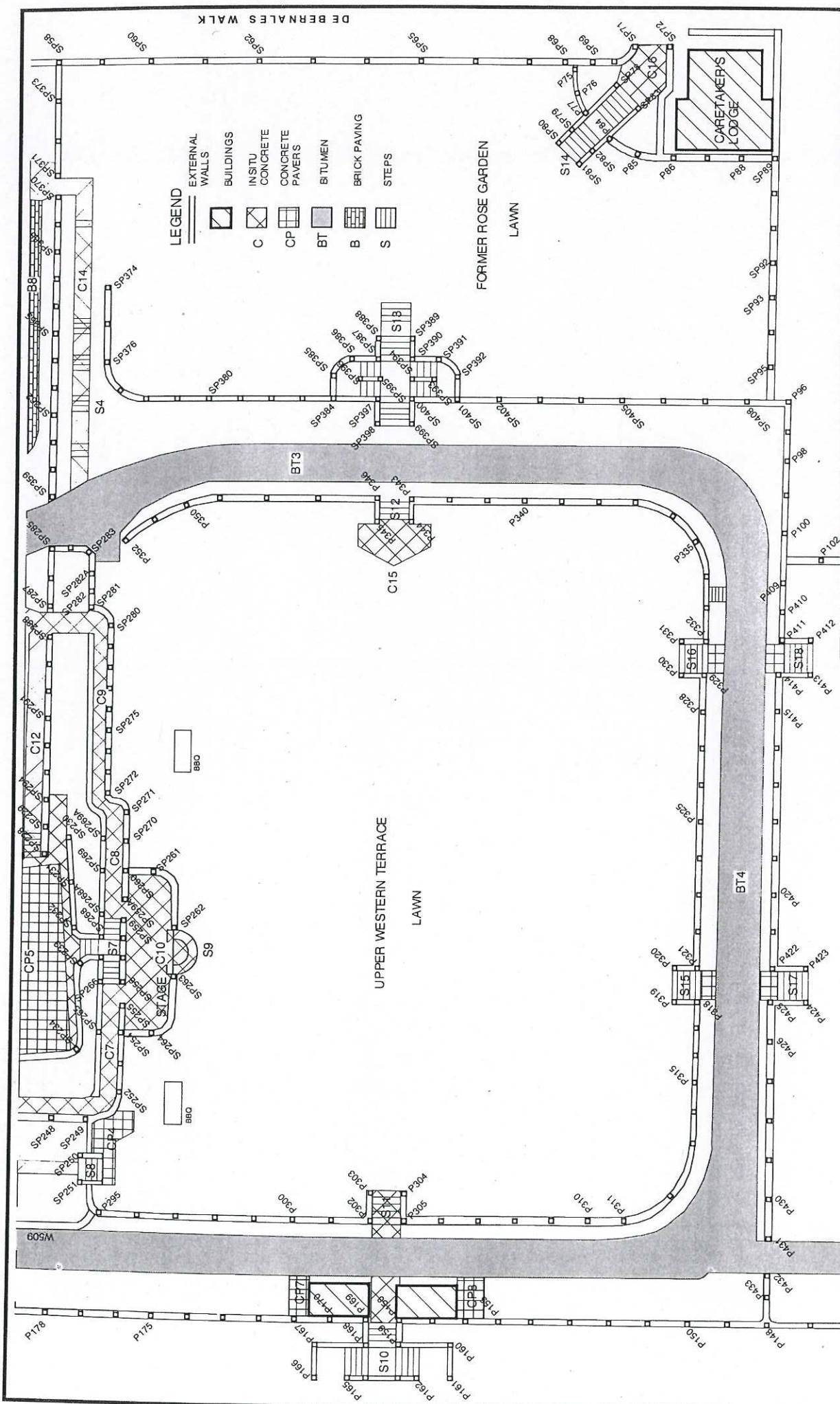

LEGEND

[Symbol]	EXTERNAL WALLS
[Symbol]	BUILDINGS
[Symbol]	INSTU CONCRETE
[Symbol]	CONCRETE PAVERS
[Symbol]	BITUMEN
[Symbol]	BRICK PAVING
[Symbol]	STEPS

DATE	MARCH 03
CLIENT	TOWN OF COTTESLOE
PROJECT	COTTESLOE CIVIC CENTRE EXTERNAL WALLS AND PAVING
JOB NO.	0075
DWG NO.	SC 5
TITLE	STRUCTURAL CONSERVATION WORKS

Maitland
Consulting Structural Engineering

Telephone : (08) 9489 4800
Facsimile : (08) 9489 4801
Email : iamcse@inet.net.au

5/ 531 Hwy St.
Subiaco
W.A. 6008

MC
SIE

AREA B
SP - BALUSTRADES/ PIER OVER
P - BALUSTRADES/ PIER UNDER
W - WALLS WITHOUT PIERS

N

0 1 2 5 10

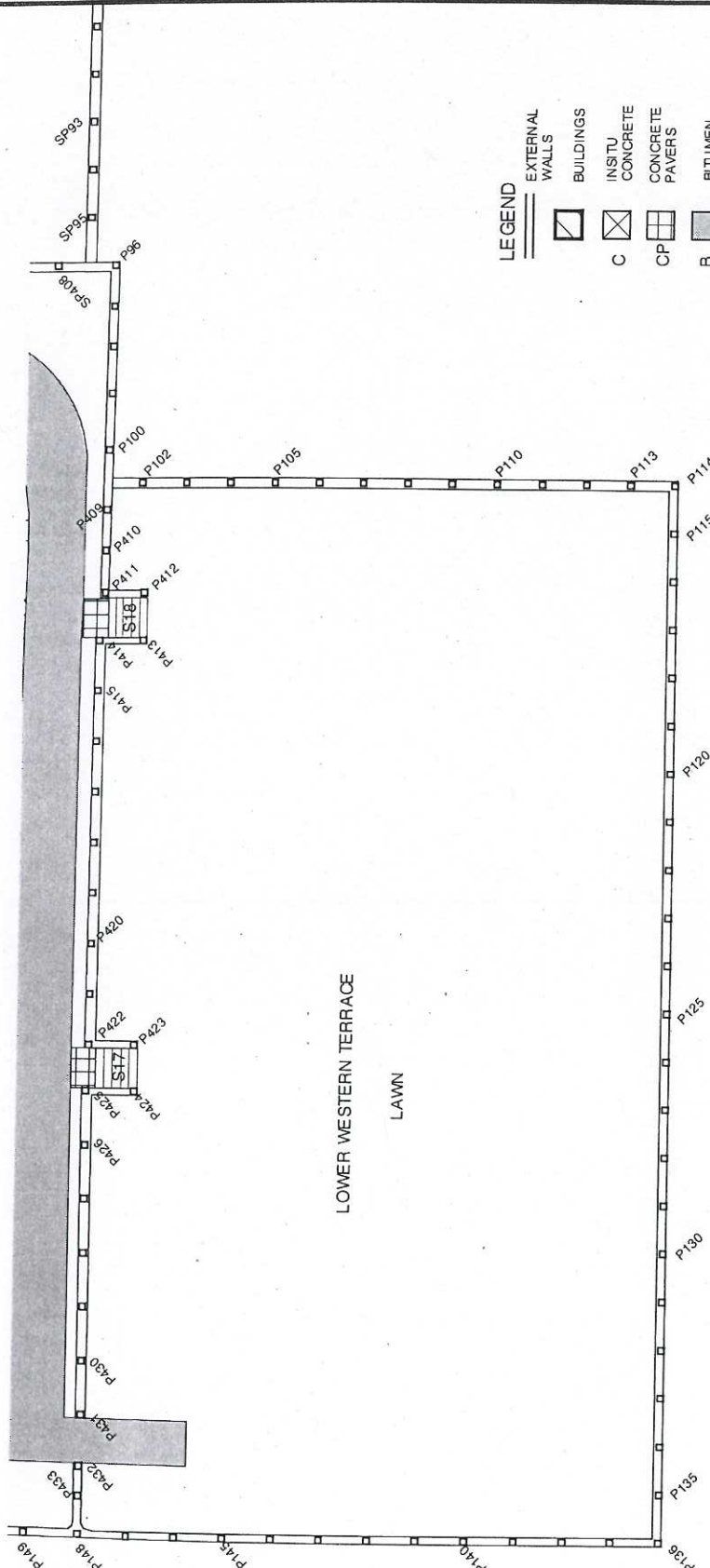

LEGEND

	EXTERNAL WALLS
	BUILDINGS
	INSITU CONCRETE
	CONCRETE PAVERS
	BITUMEN
	BRICK PAVING
	STEPS

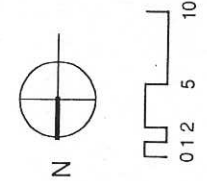

AREA C

SP - BALUSTRADES/PIER OVER
 P - BALUSTRADES/PIER UNDER
 W - WALLS WITHOUT PIERS

 Maitland Consulting Structural Engineering Telephone : (08) 9489 4800 Facsimile : (08) 9489 4801 Email : lanmcsge@inet.net.au 5/ 531 Hay St. Subiaco W.A. 6008	CLIENT	TOWN OF COTTESLOE
	PROJECT	COTTESLOE CIVIC CENTRE EXTERNAL WALLS AND PAVING
	TITLE	STRUCTURAL CONSERVATION WORKS
DATE	MARCH 03	
JOB NO.	0075	
DWG NO.	SC 6	



Town of Cottesloe

FIVE YEAR PROGRAM CIVIC CENTRE SURROUNDS - REHABILITATION

YEAR 1 – 2014/2015

Proposed works	Cost Est \$
Balustrade De Bernales Walk – southern section	40,000
Wall south of stage	100,000
Repointing and minor wall repairs	40,000
Upgrade of lights, paths, external power points, hand rails	20,000
Total	\$200,000

YEAR 2 – 2015/2016

Proposed works	Cost Est \$
Stairs to Spanish Tower from stage	120,000
Begin Spanish Tower repairs	60,000
All non-limestone walls upgrading	20,000
Total	\$200,000

YEAR 3 – 2016/2017

Proposed works	Cost Est \$
Completion of Spanish Tower repairs	60,000
Rebuild south west entry stairs	120,000
All non-limestone walls upgrading	20,000
Total	\$200,000

YEAR 4 – 2017/2018

Proposed works	Cost Est \$
Northern section wall between circuit drive and lower western terrace	180,000
All non-limestone wall upgrading	20,000
Total	\$200,000

YEAR 5 – 2018/2019

Proposed works	Cost Est \$
Wall replacement, western lawn near barbeque	80,000
Wall repairs, eastern boundary wall	80,000
All non-limestone walls upgrading	20,000
Total	\$180,000

