

SITE PLAN
DIMENSIONS IN METRES

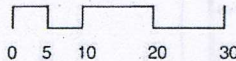

LEGEND

- EXTERNAL WALLS
- BUILDINGS
- IN SITU CONCRETE
- CONCRETE PAVER
- BITUMEN
- BRICK PAVING

SITE PLAN, MAJOR DIMENSIONS & AREAS		
<p>Maitland Consulting Structural Engineering 5/ 531 Hay St. Subiaco W.A. 6008 Telephone : (08) 9489 4800 Facsimile : (08) 9489 4801 Email : ianmcse@inet.net.au</p>	CLIENT TOWN OF COTTESLOE	DATE MARCH 2003
	PROJECT COTTESLOE CIVIC CENTRE EXTERNAL WALLS AND PAVING	JOB NO. 0075
TITLE STRUCTURAL CONSERVATION WORKS	DWG No. SC-1	

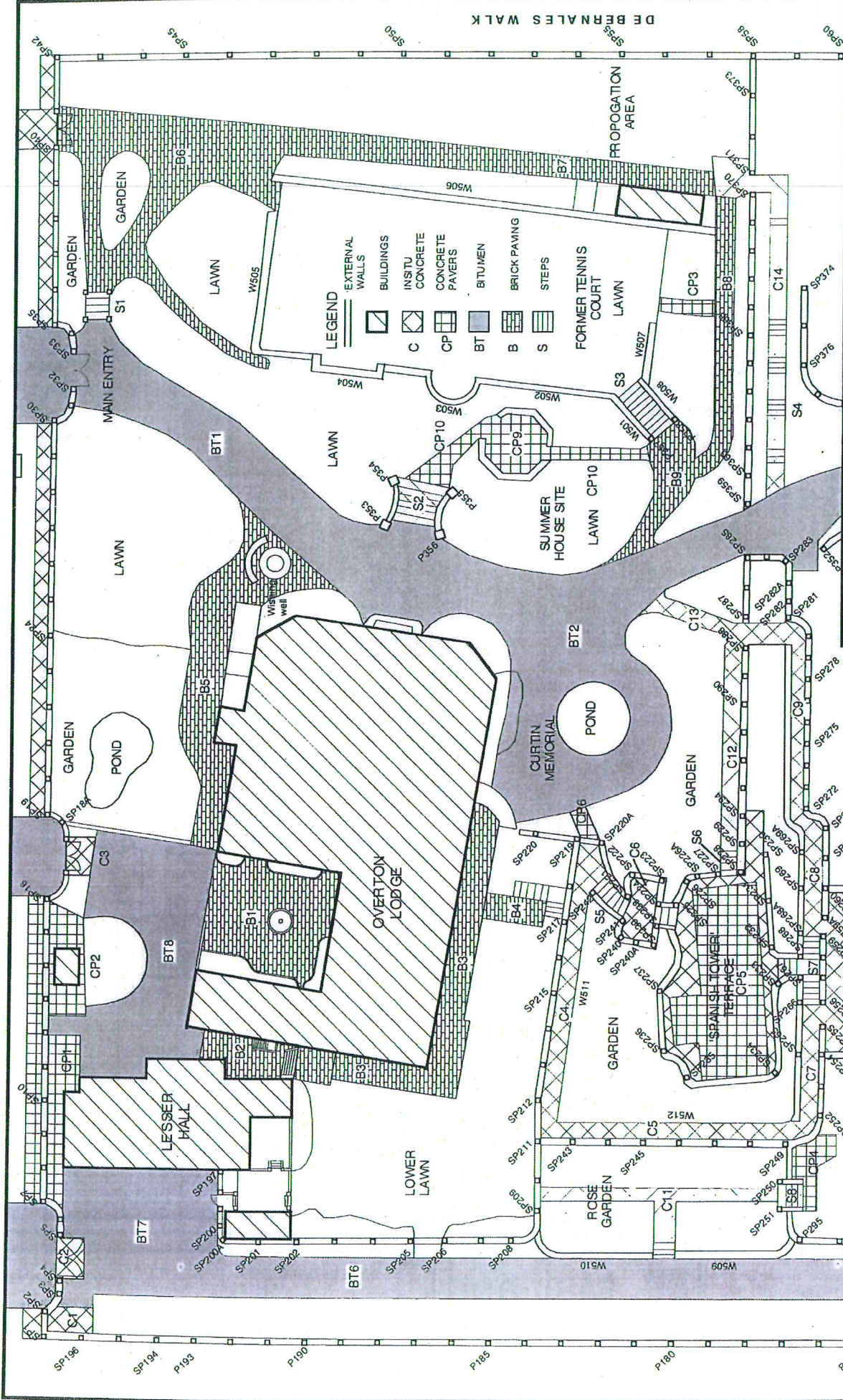

DATE	MARCH 03
CLIENT	TOWN OF COTTESLOE
PROJECT	COTTESLOE CIVIC CENTRE EXTERNAL WALLS AND PAVING
JOB NO.	0075
TITLE	STRUCTURAL CONSERVATION WORKS
DWG NO.	SC 4

Maitland
 Consulting Structural Engineering
 Telephone : (08) 9489 4800
 Facsimile : (08) 9489 4801
 Email : lamcse@inet.net.au

MC SIE
 5/531 Hay St.
 Subiaco
 W.A. 6008

- SP - BALUSTRADES/PIER OVER
- P - BALUSTRADES/PIER UNDER
- W - WALLS WITHOUT PIERS

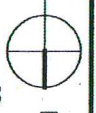

0 1 2 5 10

AREA A

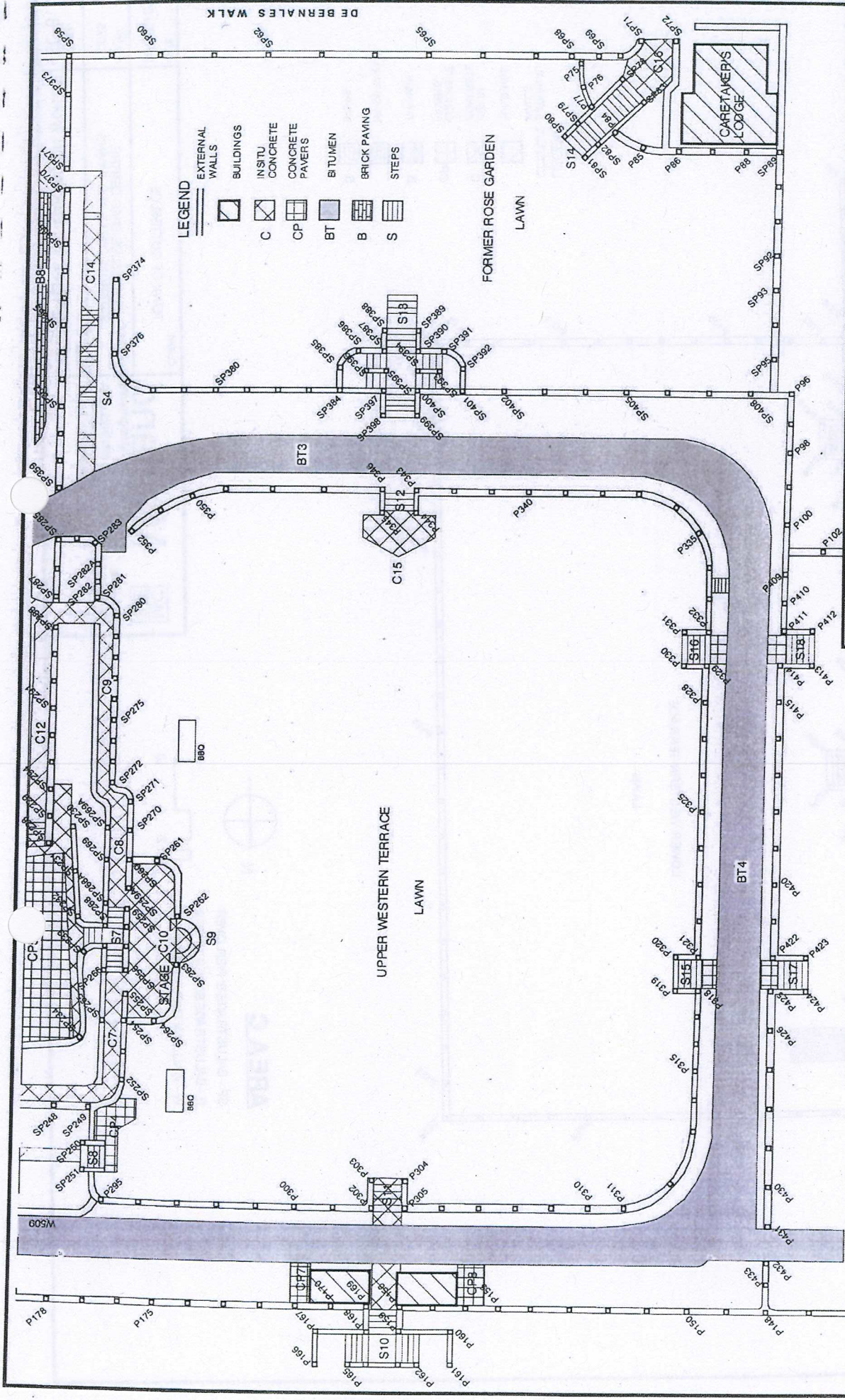

DATE	MARCH 03
CLIENT	TOWN OF COTTESLOE
PROJECT	COTTESLOE CIVIC CENTRE EXTERNAL WALLS AND PAVING
TITLE	STRUCTURAL CONSERVATION WORKS
JOB NO.	0075
DWG No.	SC 5

Maitland
Consulting Structural Engineering

Telephone : (08) 9489 4800
Facsimile : (08) 9489 4801
Email : ianmce@inet.net.au

MC SE
5/531 Hay St.
Subiaco
W.A. 6008

AREA B

SP - BALUSTRADES/ PIER OVER
P - BALUSTRADES/ PIER UNDER
W - WALLS WITHOUT PIERS

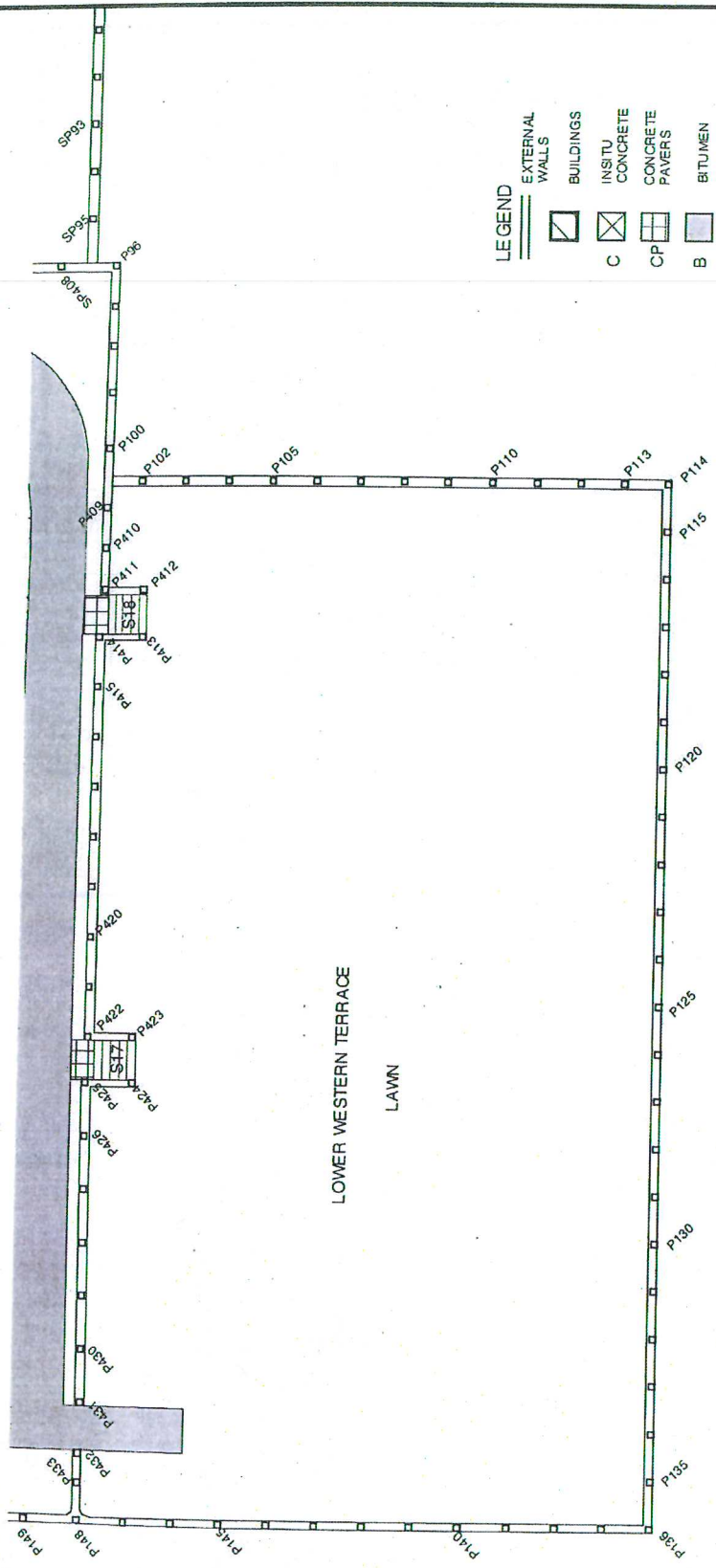



Town of Cottesloe

5 YEAR PROGRAM CIVIC CENTRE SURROUNDS - REHABILITATION

YEAR 1 – 2013/2014

Proposed works	Cost Est \$
Limestone wall works – as listed	190,000
Surrounds lighting upgrade – PT2	15,000
Improvements to main wall footings and structural stability	15,000
Total	\$220,000

YEAR 2 – 2014/2015

Proposed works	Cost Est \$
Limestone wall works, as listed	206,000
Total	\$206,000

YEAR 3 – 2015/2016

Proposed works	Cost Est \$
Limestone wall works, as listed	181,000
Replace / upgrade external power mains and connections	20,000
Total	\$201,000

YEAR 4 – 2016/2017

Proposed works	Cost Est \$
Limestone wall works, as listed	160,000
Capital works – gardens upgrade	20,000
Total	\$180,000

YEAR 5 – 2017/2018

Proposed works	Cost Est \$
Limestone wall works	140,000
Capital works – large tree removals and replacements	20,000
Total	\$160,000

