



EXISTING SITE 1:1000



EAST COTTESLOE POS PLAYGROUND

INITIAL CONCEPT PRESENTATION
06/04/2022



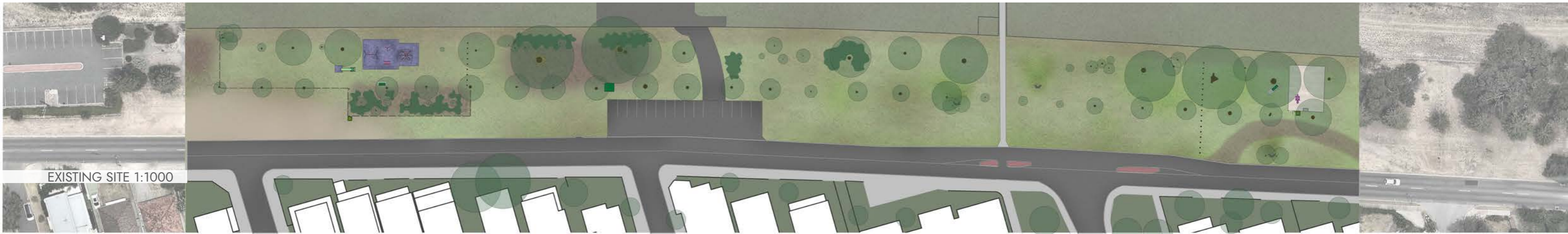

EXISTING SITE 1:1000

CONCEPT BRIEF

A landscape/playground design which spans between the existing playgrounds Purple Dinosaur(N) and Railway x Albion Park(S). The intent would be for both Albion Park and the Purple Dinosaur Playground to be integrated as one major facility along Railway Street. The design vision of the working group would be to incorporate play facilities that creates an area for children and youths of all ages.

There are specified areas and age groups the Town of Cottesloe wishes to cater for. These different areas of the project should be cohesive, uniting to form a space that in its entirety is greater than the sum of its parts. Integrated, yet separate.

DEFINED REQUIRED AREAS:

- 0-6 yr Olds - Replace Purple Dinosaur park, fenced sandpit with *Little Tikes* plastic dinosaur and community toy library.
- Skills track - Beginner bike track, learn how to ride and the basics of road rules
- Pump Track - More advanced bike track, berms and bumps. Natural texture to fit with master plan aesthetic.
- Free Play - Imaginative engagement, non-directive nature play. Embrace the area existing beautiful fig trees.
- 6-13 yr olds - Replace/Upgrade for Albion St park, *Megatoy Playground Solutions* playground on rubber softfall
- 13-17 yr olds - Space for young teens, a place the can take ownership of. Consider Sports area vs Playspace

TARGET BUDGET:

\$300,000 +gst

EXISTING SITE ANALYSIS.

SITE AREA:

5800 m2 total approximate: 0-6yrs: 150m2 | Skills Track: 140m2 | Pump Track: 350m2 | Free Play: 300m2 | 6-13yrs: 175m2 | 13-17yrs: 140m2

Existing Vegetation:

- 68x Existing Trees +shrubs, incl:
- 2x Large Fig Trees.
- 25x Norfolk Island Pines. Varying in scale, planted in linear formation
- 4x Bottlebrushes. Located around the water overflow runoff points
- Native Garden
- Wild grassed open space. Average condition, Includes patches of sand/prickles.

Existing Maintenance:

Minimal Maintenance.
Ride on mower through space. No water/retic.

Existing Amenities:

- 2x Playgrounds. As shown below.
- Bins and Dog Waste Bags at either end of site.
- Parking. As well as the paved bays, parking is common all along site
- Natural green corridor.
- Dog walking space
- Bird habitat

Other Notable features:

High visibility from adjacent train line.
P2P Cycle path opposite train line, crossing access path exists mid site.
Residential Area opposite Railway St.



EXISTING PLAYGROUND (SOUTH)
- ALBION ST



2x LARGE SPRAWLING FIG TREES



NATURE CORRIDOR - EXISTING TREES



EXISTING PLAYGROUND (NORTH)
- PURPLE DINOSAUR



EXISTING SITE - STREET VIEW PHOTO MONTAGE

EAST COTTESLOE POS PLAYGROUND

COMMUNITY FEEDBACK AND PROJECT GOALS

Adventurous play equipment with safe fences between roads and play zones. Shade and seating

Any play space for very young children must be fenced for parent reassurance and to again keep friendly dogs out. Also shade is very important.

Pump Track!

Toilets

The play ground with nature feel to them. So the kids have to be creative in there play. Also keep the trees

NATURE

Pump Track

Access to drinking water for people and pets

PLAY

The nature that is already there should be nurtured as much as possible. We can build on what is there.

"A combination of child activities and more amenities such as pathways, water fountains and more bins would be useful. A fence enclosing the trees along the length of Railway Street would be ideal for dog exercise area.

Trees, trees, bushes and more trees.

Active Play

shade in summer

Public toilets.

Cafe / A food caravan selling coffee and snacks.

Water + Sensory play, innovative design - not out of a catalogue.

Active play - basketball hoop for teenagers

Trees, trees, bushes

Definitely need some things for bigger kids - flying fox, pump track, basketball court

and more trees.

Once established ongoing maintenance of the areas to keep an inviting natural landscape which will attract people to these spaces.

SHADE!



A HOLISTIC CONCEPT EXPRESSIBLE IN 3 KEY BELIEFS

The design creates a natural corridor through the 300m long site.

A design is driven by a series of beliefs.

If we hold true to these beliefs the overarching theme and character of the space will remain strong and the feeling that each element is a part of something larger. An ecosystem of play spaces.

The key beliefs we have tried to follow in this project are outlined below.

CONVICTION 01 - A NATURAL CORRIDOR:

The natural corridor, a calming space of organic character and connection to nature.

Represented most iconically by a raw surfaced path, weaving through the landscape connecting a series of play opportunities for differing age groups.

There are no straight lines in nature, with this path we aim to counteract the strict lines that have been imposed on the site previously.

CONVICTION 02 - IMAGINATIVE ENGAGEMENT FOR CHILDREN :

The imagination of children is most activated during play.

To spark this imagination we create spaces that they must decipher, challenge, explore, and make their own. The best opportunities for this style of play include those which are open to interpretation.

CONVICTION 03 - CONNECTION TO THE PAST:

The Purple Dinosaur was seen as an iconic feature to some residents. Creating reference where possible to dinosaurs and prehistoric times we can embrace the natural and also pay due respect to the removed play piece.

Carvings in timber and stone, select plantings and a dinosaur inspired timber play sculpture all honour this connection.

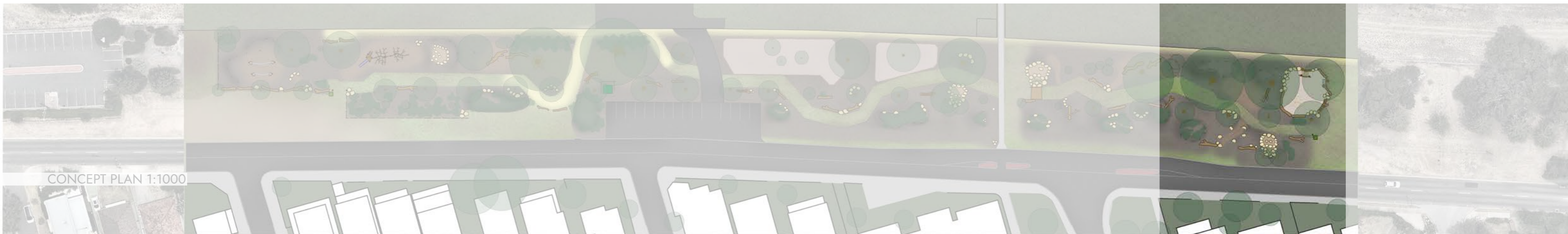

TODDLER SPACE
(0-6 yrs)

The sandpit has been expanded to a natural shape, edged with large logs and rocks. The toy library remains, with a large expanse of open sand for play.

In a shallow corner of the sandpit are some large flat rocks with carvings of dinosaur fossils and other natural relics. A large log with bowls creates a space where found gum nuts, leaves, and other found pieces can be collected/mixed.

Mirroring the sandpit it a large open hollow, filled with softfall grade mulch it offers an isolated free play space for small children.

This space also marks one terminal point of the natural path which winds through the natural corridor.

We start with a stone edged oasis, populated with reeds and sedges towards the mouth and large balancing rocks in the pool. The oasis is edged by two existing bottlebrush trees and is filled with 300mm of coarse river sand. This will allow the water from the overflow pipe to disperse into the ground without pooling or eroding new channels through the space.

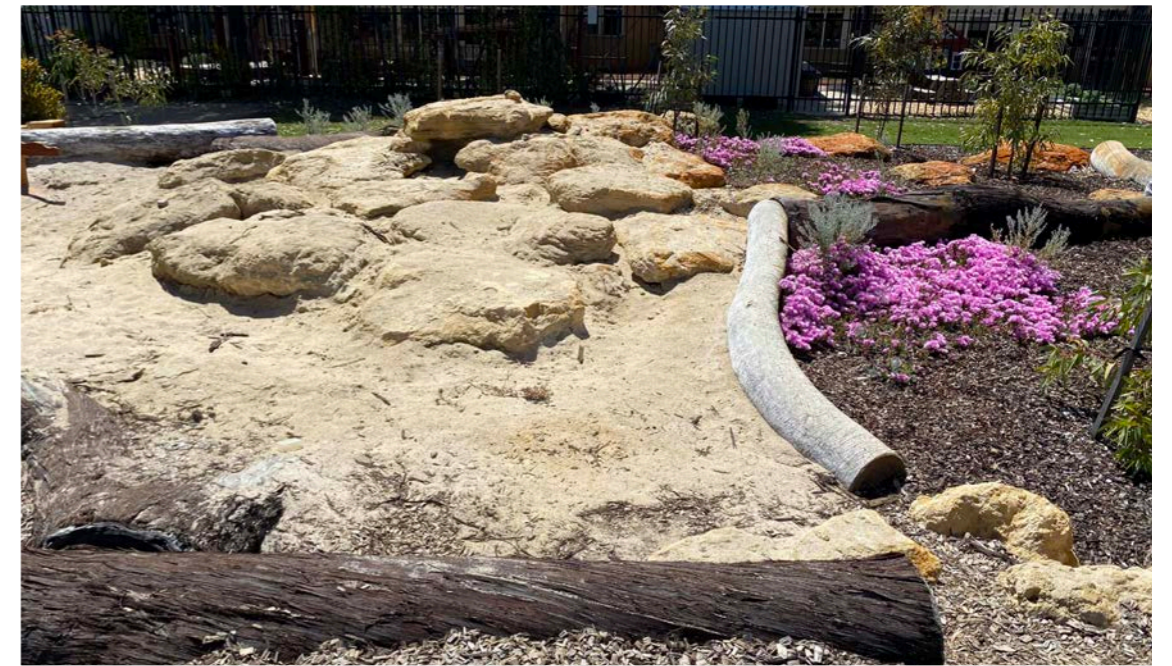

The Purple Dinosaur which was the namesake of this park has been removed. While the piece provided some play value, it was not a unique item and does not connect with the overarching theme of the Natural corridor



The discoverable stone fossils are a homage to the plastic dinosaur, which will be relocated to another location in Cottesloe. The existing Toy library (right) will be retained.



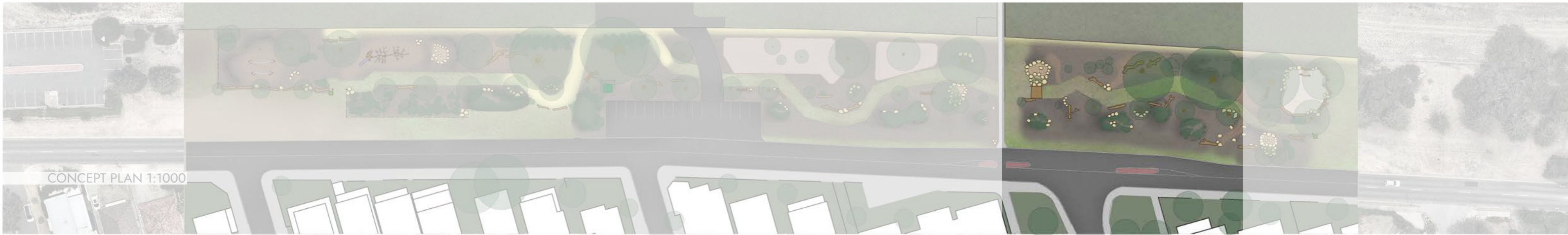

QUIET SPACE
(ALL AGES, ADULTS incl.)

The nature corridor.
Dog friendly, wide access path

As the path winds through the space, a series small mounds and swales with interspersed large logs and rocks present new opportunities you can detour off path to visit. Native under story planting will help to enhance the biodiversity of the site and create a more attractive home for birds. Though called a quiet space this area presents limitless opportunities for play, running, and exploration.

Pending budget and availability we would like to include some established Macrozamia plants. Known affectionately by children as dinosaur plants, these have existed relatively unchanged for millions of years.

Near the end of this space is a second overflow oasis. This time with a fairy bridge crossing along the path, which conceals the output pipe.



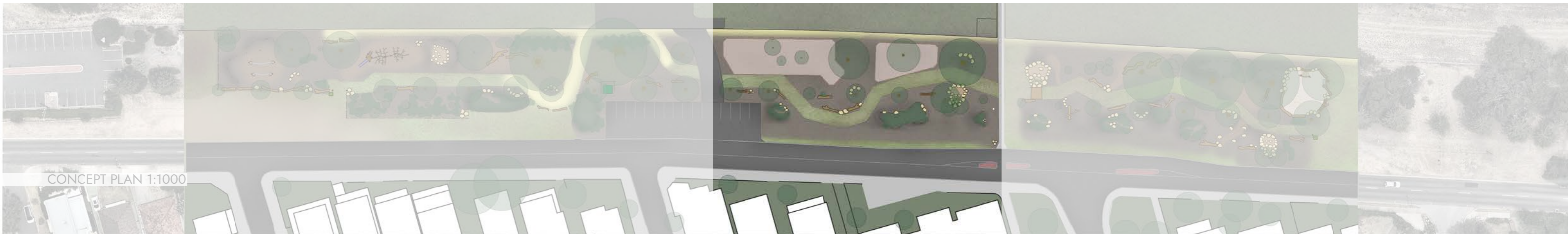

BIKE TRACKS (PUMP TRACK & SKILLS TRACK)

The existing footpath/ train line crossing provides a halfway point for the project. We have selected this as the site of a dual bowl, dog accessible, water fountain.

The continuing natural path meets a third overflow oasis, this one has a neighbouring log bench. Installed where guardians can watch over the small children who will be using the Skills track on the other side of the path.

The planted area adjacent to the Pump track allows a range of spots for sitting and watch the track in action. It also acts as a barrier between the paved car park and the park enjoyer.

Three Chillies Design has been awarded the design of the skills/pump tracks and are currently working on a concept plan.

Potential funding for construction may be available from DoT as part of activation of P2P cycle path.

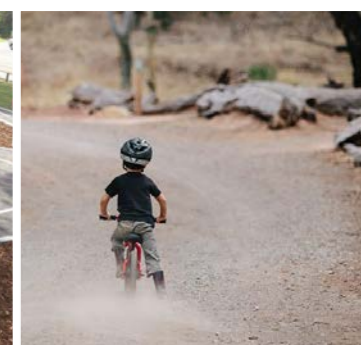

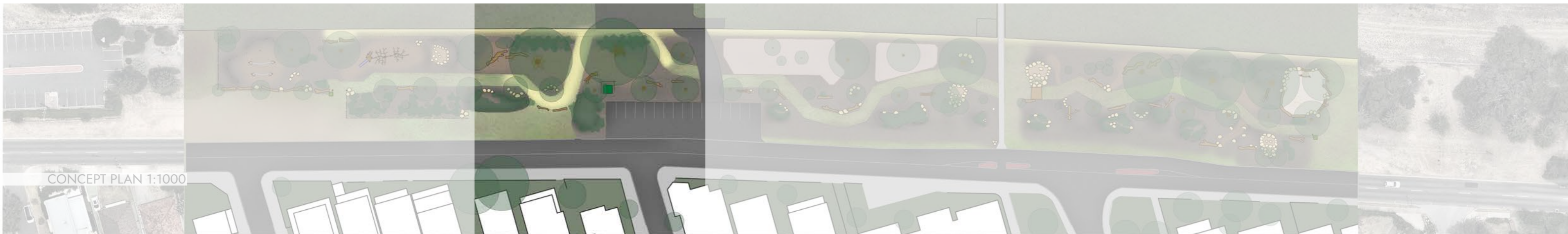

CONCEPT PLAN 1:1000



CONCEPT PLAN 1:300

FREE PLAY
(Under Canopy Burrow - All ages)

The beauty of a great natural space is that it needs minimal work, just accentuation of the properties which already exist.

As the natural path weaves through the two Fig trees, we have only intervened slightly. Some pruning and a layer of mulch under the large trees.

In this portion the path has been raised slightly to with a stabilised crushed stone. A new log bench has been installed as a resting place for guardians supervising play. The utility box has also been surrounded with a music wall. A range of interactive sensory fixings.

As you emerge from the burrow, there is a small clearing with two select large balancing logs. They will be chosen for natural character which complements the long arms of the fig trees.



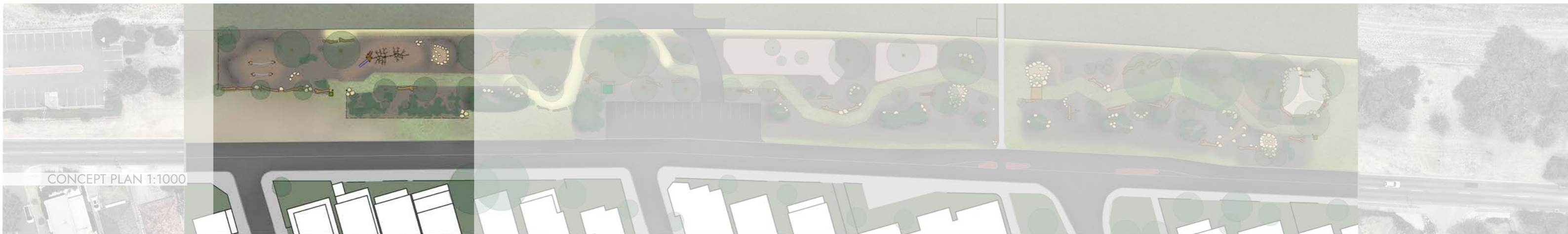

CONCEPT PLAN 1:1000



CONCEPT PLAN 1:300

The above design does not show the existing shade sails.

It is our intention that they would remain.
The final details will be determined in design development.

The intention is for the existing centre steel post to be replaced with a large timber post which forms part of the new timber climbing structure.

PLAY GROUND & TEEN SPACE (6 yrs + / 13 yrs +)

From a rock crater in the ground a skeletal timber structure has emerged. Continuing the connection to the dinosaur, it's scale and form is of a mythical creature. The frame of twisted timber bones is large enough to support climbing over whilst retaining enough room underneath for rope swings and scrambling opportunities. At the "head" of the dinosaur a stick ladder leads up two perch platforms with a 1800mm slide descending.

The natural path ends here, we have relocated the bin and dog bags to an assigned entry/exit point. If you, despite the end of the path, continue further along, you reach the 13-17 yr old space. Sheltered amongst mounds and trees on all sides, there are four timber giants (pictured left). The giants are connected by two large ropes. This creates an opportunity for challenging balancing, light swinging, or just sitting and talking.

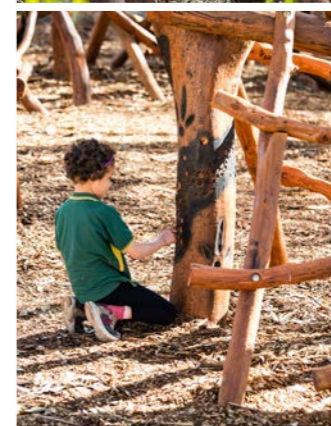



CONCEPT REVIEW

BUDGET:

The target budget for this project is \$300,000 +gst

The design outlined in this document is still under development. The intention at this stage of design is to show proof of concept and outline the potential of the site. This design relies on involvement for council and community contribution.

With approval of the concept, the client and design team will work together to prioritise these opportunities and to develop the concept into a suitably priced concept which delivers the best outcomes possible.

An initial estimate of the above design would be \$300 - \$350k

Estimated Price Breakdown:

Below are estimates, but give an idea of where the budget has been allocated. Please refer to the attached scope/notes pages on each area

Bike Tracks, pump and skills	-	\$100,000 +gst
0-6 yr olds playground	-	\$40,000 +gst
6-13 yr olds playground	-	\$65,000 +gst
13-17 yr olds space	-	\$25,000 +gst
Alternative Design (B Ball)	- additional	\$10,000 +gst
General landscape site works	-	\$70,000 +gst
Including:		
- Existing Playground Demo	-	\$5,000 +gst
- Earthworks (Grass demo/sculpting)	-	\$20,000 +gst
- 3x Rock oases, with sand/reeds	-	\$20,000 +gst
- Planting (under story) (~415 m2)	-	-\$6,000 +gst

SURFACE TREATMENTS:

Landscape Mulch
Sofffall Grade Mulch
Screened White Sand
Coarse river sand.

PATH OPTIONS:

Existing surface (wild grass)
Stabilised stone fines
Crushed limestone
Crushed brick

SAFETY CONCERNS:

Nature play carries an inherent amount of risk. This is a good thing, the benefits of playing with acceptable risk are vast and well documented.

The space will be subject to an independent safety audit to meet Australian Standards.

- Fall zone areas all have sufficient IAS specified
- Natural rocks/timbers will be safety edged, with prominent sharp points removed.

OTHER REQUESTED FEATURES:

Sport Court:

A sports court was determined as a possible inclusion for the 13-17 yrs old space.

We have obtained a quote to install a 10x15m basketball half court. The court would require an additional landscaping budget to make sure it sits as though it belongs to the space.

