



SITE PLAN – LOT 32 - 7 NAPIER STREET, COTTESLOE

<p>PLAN OF <u>PORTION OF COTTESLOE SUB LOT 41 AND</u> <u>BEING LOT 32 ON PLAN 5932</u></p> <p>CERTIFICATE OF TITLE <u>REFER TO SCHEDULE</u> <u>GOVERNMENT</u></p> <p>LOCAL AUTHORITY <u>TOWN OF COTTESLOE</u></p> <p>LOCALITY <u>COTTESLOE</u> INDEX PLAN <u>PERTH 2000 07.20</u></p> <p>NAME OF BUILDING <u>SCHEME</u> <u>PARKSIDE TOWERS</u></p> <p>NAME OF BODY CORPORATE _____ (IF STRATA PLAN OF SUBDIVISION OR CONSOLIDATION) <u>OF PARCEL</u></p> <p>ADDRESS FOR SERVING OF <u>7 NAPIER STREET</u></p> <p>NOTICES ON COMPANY <u>COTTESLOE WA 6011</u></p> <p>PURPOSE <u>SEE ANNEXURE 'A'</u></p>	<p>CA 1</p> <p>STRATA PLAN 32021</p>  <p>OFFICE USE ONLY</p> <p>LODGED <u>30.10.96</u> <u>142249</u></p> <p>EXAMINED <u>6.11.96</u> <u>STH</u></p> <p>REGISTERED <u>15.9.97</u> <u>App 6583429</u></p> <p><i>John J. ...</i>  REGISTRAR OF TITLES</p>
<p>CERTIFICATE OF TITLE - SCHEDULE 1282/758; 1282/759; 1282/760; 1282/761; 1283/52; 1283/53; 1283/977; 1284/459; 1290/825</p> <p>NAPIER STREET</p>	
	

S32021							
Lot Number	Part	Register Number	Unit Entitlement	Lot Number	Part	Register Number	Unit Entitlement
1		2114/455	124	2		2114/456	84
3		2114/457	124	4		2114/458	121
5		2114/459	87	6		2114/460	125
7		2114/461	122	8		2114/462	88
9		2114/463	125				

TOWN OF COTTESLOE

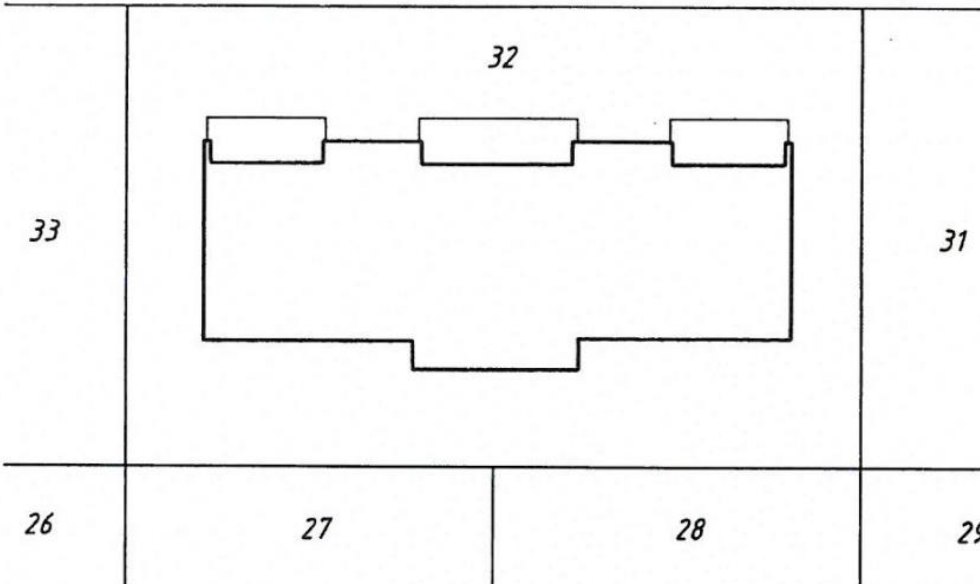
DATE RECEIVED

26 August 2024

FLOOR PLAN – 6 / 7 NAPIER STREET, COTTESLOE LOCATED ON FIRST FLOOR OF APARTMENT BLOCK

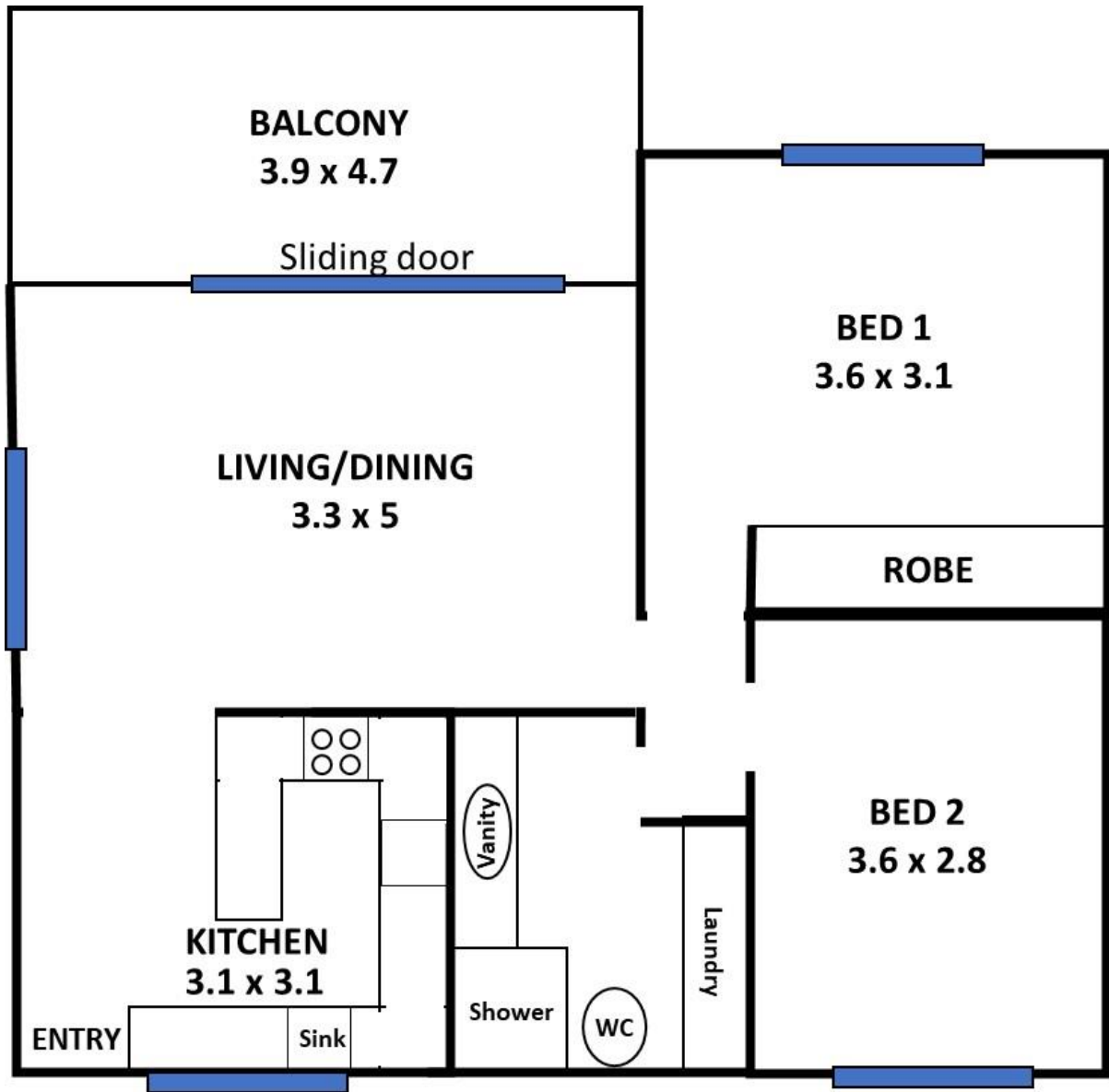

TOWN OF COTTESLOE

DATE RECEIVED

26 August 2024

VIEW OF BUILDING AT LOT 32 - 7 NAPIER STREET, COTTESLOE

UNIT 6 IS OUTLINED IN RED

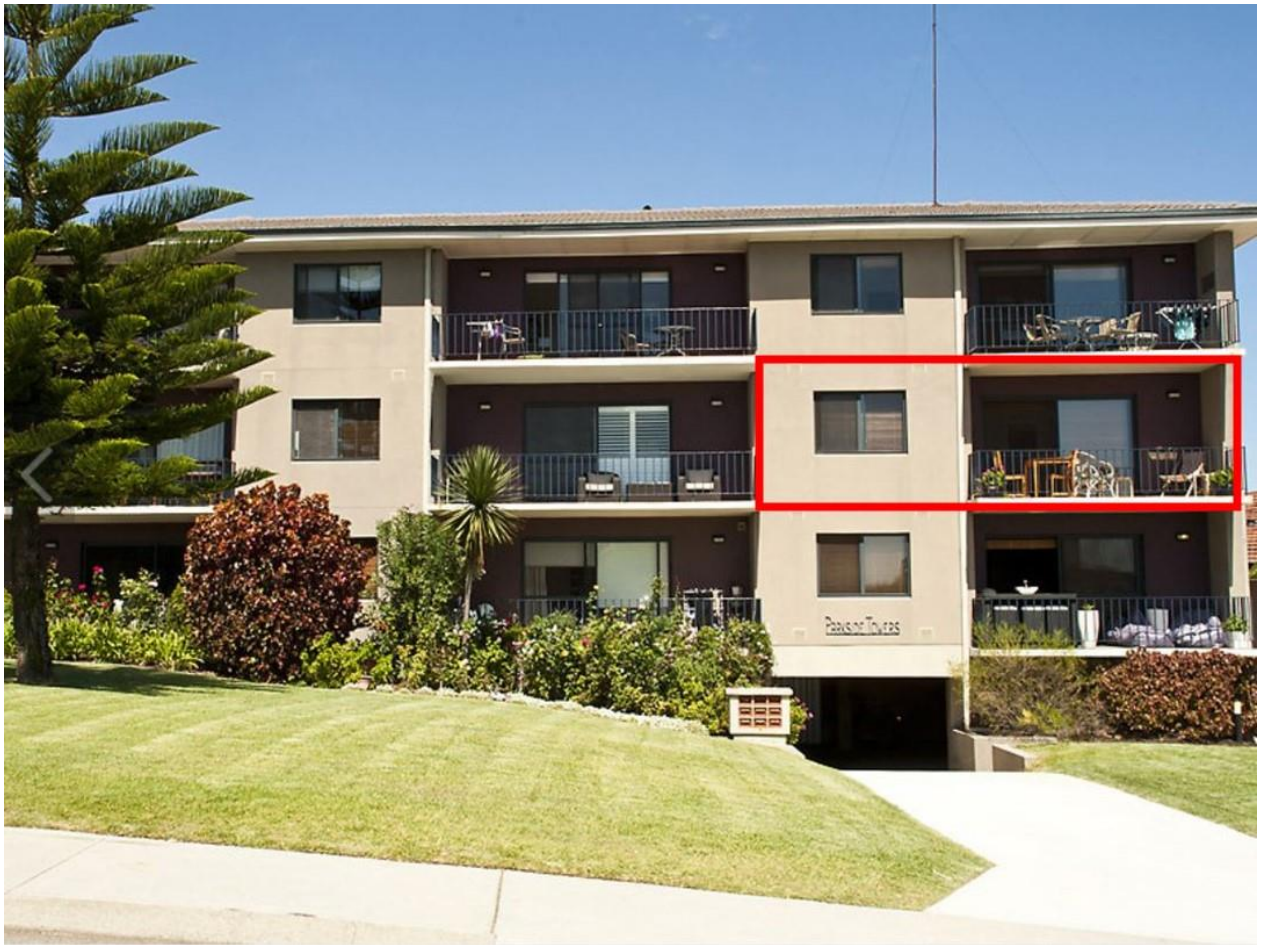

TOWN OF COTTESLOE

DATE RECEIVED

26 August 2024